



# Dried Plum News



Volume 1, Issue 1

February 2004

## SAN JOAQUIN VALLEY DRIED PLUM DAY

Tuesday, March 2, 2004

University of California Cooperative Extension  
Tulare County  
4437 S. Laspina St. B, Tulare, CA (*see map*)

### Free Half-Day Meeting

- 8:00 - 8:20 a.m.      **Registration**
- 8:20 - 8:30 a.m.      **Welcome**  
*Moderator: Brent Holtz, Madera County UC Farm Advisor*
- 8:30 - 9:00 a.m.      **Irrigation Management in Dried Plum**  
*Dr. Ken Shackel, Pomology Department, UC Davis*
- 9:00 - 9:30 a.m.      **Integrated Prune Farming Practices (IPFP)**  
*Bill Olsen, Butte County UC Farm Advisor*
- 9:30 - 10:00 a.m.      **Economic Analysis of Reduced Risk Practices**  
*Dr. Karen Klonsky, Ag Economics Department, UC Davis*
- 10:00 - 10:15 a.m.      **Break**
- 10:15 - 10:45 a.m.      **New Dried Plum Varieties**  
*Carolyn DeBuse, Pomology Department, UC Davis*
- 10:45 - 11:15 a.m.      **Managing Nitrogen in Prunes**  
*Dr. Franz Niederholzer, Sutter & Yuba Counties, UC Advisor*
- 11:15 - 11:45 a.m.      **Topping Dried Plum Trees**  
*Maxwell Norton, Merced County UC Farm Advisor*

Adjourn

University of California  
Cooperative Extension  
4437-B S. Laspina St.  
Tulare, CA 93274  
(559) 685-3303

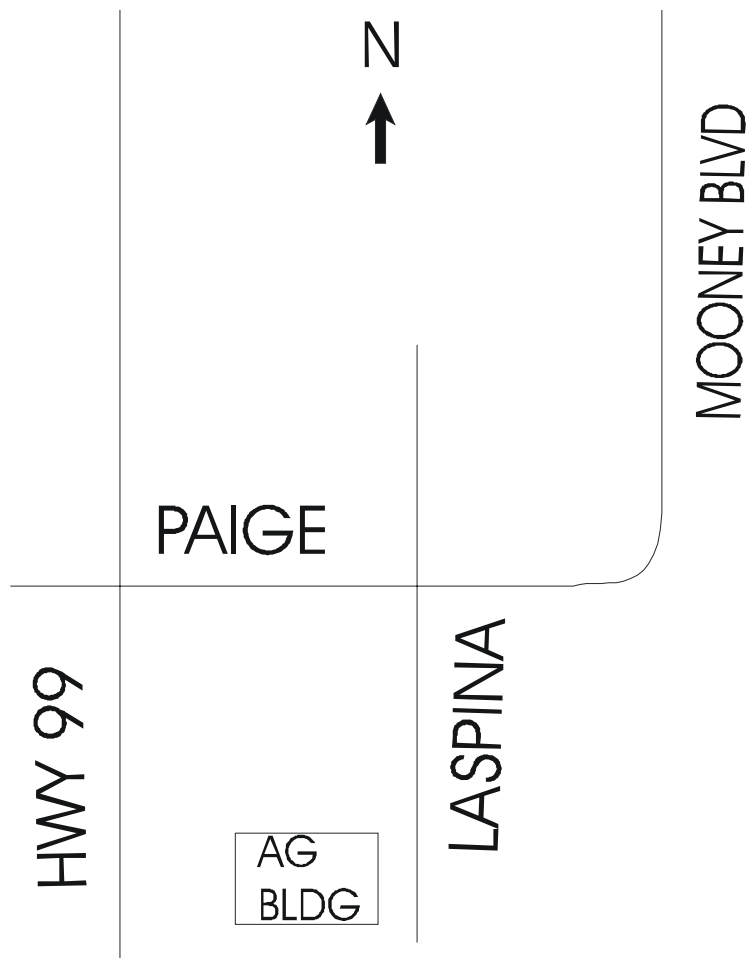

University of California  
Cooperative Extension  
4437-B S Laspina St  
Tulare, CA 93274

First-Class Mail  
US Postage Paid  
Visalia, CA 93277  
Permit No. 240

# Dried Plum News

**February 2004**



**Kevin Day**

Farm Advisor

The University of California prohibits discrimination against or harassment of any person on the basis of race, color, national origin, religion, sex, physical or mental disability, medical condition (cancer-related or genetic characteristics), ancestry, marital status, age, sexual orientation, citizenship, or status as a covered veteran (special disabled veteran, Vietnam-era veteran or any other veteran who served on active duty during a war or in a campaign or expedition for which a campaign badge has been authorized). University policy is intended to be consistent with the provisions of applicable state and federal laws. Inquiries regarding the University nondiscrimination policies may be directed to the Affirmative Action Director, University of California, Agriculture and Natural Resources, 300 Lakeside Drive, 6<sup>th</sup> Floor, Oakland, CA 94612-3560. (510) 987-0096.